

30' SPORT CRUISER

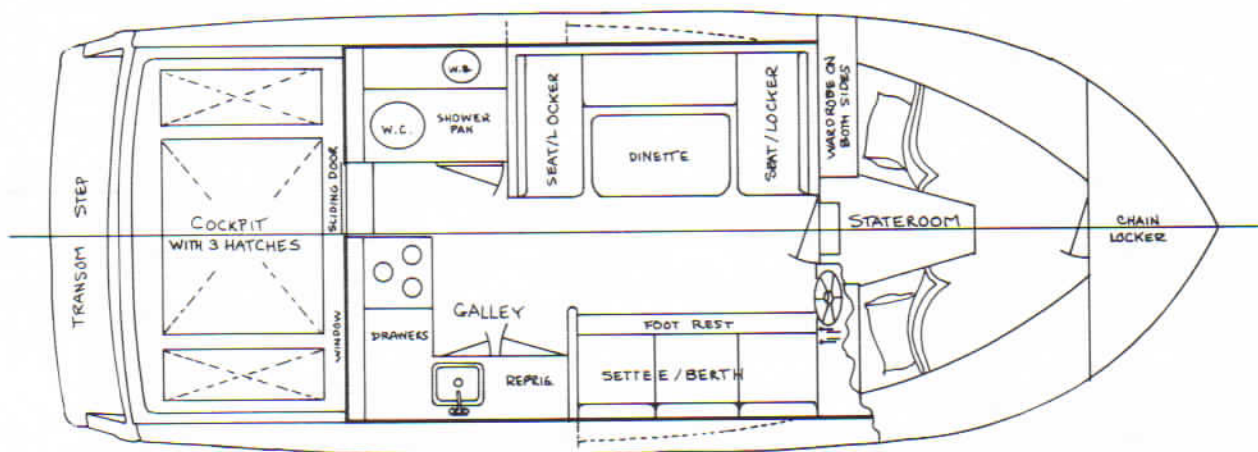

30' SPORT CRUISER SPECIFICATIONS

Centerline Length	30'6"	9.30 m
Centerline Length Including Bow Pulpit & Swim Platform	33'0"	10.06 m
Beam	11'6"	3.51 m
Freeboard Forward	58"	1.47 m
Freeboard Aft	45"	1.14 m
Height Above Waterline	9'10"	3.00 m <i>TOP OF VENTURE</i>
Draft	33"	.84 m
Fuel Capacity	197 Gal.	746 l
Water Capacity	49 Gal.	185 l
Holding Tank Capacity	28 Gal.	106 l
Weight (Average Displacement) ...	11,000 lbs.	4990 kg
Headroom in Cabin.....	6'3"	1.91 m
Cockpit Area.....	45 Sq. Ft.	4.1 Sq. M.
Sleeping Accommodations	6	

STANDARD EQUIPMENT

PROPULSION

Twin 260 Mercury V-Drive (FWC)

HARDWARE & MISCELLANEOUS

EXTERIOR ITEMS

Anchor w/Rode, Chocks, Deck Pipe
& Chain Stop
Bow & Stern Staffs
Cleats, 1 Bow, 2 Stern, 2 Springline
Electrolysis Bonding System
Feature Stripes, Deck, Bridge,
& Hull, Dark Blue
Gunwale Trim, Vinyl w/Stainless Steel
Insert
Handrails & Rail Fittings, 1" #316
Stainless Steel
Hardware, Stainless Steel & Chromed
Brass
Horn, Electric
Ladder, Cockpit to Bridge, Stainless Steel,
w/Teak Steps
Mooring Lines (3)
Ships Bell
Transom Step, Fiberglass
Weather Cover, Cabin Windshield

ENGINE ROOM & BILGES

Belt Covers, Engines
Bilge Blowers
Bilge Pumps, Automatic (2)
Fuel Filters, Gas
Fuel & Water Level Indicator
Intake Water Valves (Ball Valves)
Lights, 12 Volt
Mufflers
Oil Change Pump System (Main
Engines) 12 Volt
Propeller Shafts, 1 1/4", Stainless Steel
Rudders, High Test Bronze
Sewage Holding Tank (28 Gallons)
w/Hand Pump for Waterline Discharge,
Deck Discharge & "Y" Valve

Shorepower Receptacle (120 Volt)
Sound Insulation
Struts, Bronze w/Cutlass Bearings
Through Hull Fittings, Bronze Below
Waterline, Nylon & Bronze Above
Twin, Gas, Fresh Water Cooled
Engines, w/Marine Gears, Adjustable
Engine Mounts & Heavy Duty Alternator

ELECTRICAL SYSTEMS & COMPONENTS

Alarm System, Audio, Temperature & Oil
Batteries (2-105 AMP, Main Engines)
Battery Isolator
Battery Switch, Vapor Proof
Electrical Distribution Control Panels
w/Magnetic Circuit Breakers, Amp & Volt
Meters (12 Volt & 120 Volt)
Lights, 12 Volt
Navigation Light
Outlets, 120 Volt, Duplex
Pressure Water System & Water Heater
w/120 Volt Heat Exchanger, 10 Gallon
Shorepower Cord (1-50 AMP, 50')

SALON/GALLEY

Carpet w/Pad
Dinette, Raised w/Table (Converts to Berth)
Dish Cabinets
Door, Sliding, Access to Cockpit
Draperies, Lined (Panels)
Interior Woodwork, Teak
Lights, 12 Volt
Lockers
Mini-blinds
Pastry Board
Range, 3 Burner w/Oven (Propane)
w/Tank & Regulator
Refrigerator (12 Volt/120 Volt)
Settee, Convertible
Sink, Stainless Steel
Trash Bin (Below Cutting Block)

30' SPORT CRUISER (Continued)

FORWARD STATEROOM

Carpet w/Pad
Chain Locker in Forepeak w/Door, Mirrored
Deck Hatch w/Screen
Door, Privacy
Draperies, Lined
Fabric Padded Hullsides (V-Berth)
Hanging Lockers
Interior Woodwork, Teak
Lights, 12 Volt
Portlight w/Screens, Stainless Steel
V-Berth w/Filler Pad

HEAD

Carpet w/Pad
Countertop & Sink, Marbleized
Door, Privacy
Drawers
Head, PH 2, Raritan
Holding Tank Level Indicator
Interior Woodwork, Teak
Lights, 12 Volt
Mirror
Shower Pan w/Drain Pump
Towel Bar, Paper Holder & Soap Dish

MISCELLANEOUS INTERIOR EQUIPMENT

Air Ventilator, Storage Lockers
Countertops, High Pressure Laminate
Decor, Decorator Coordinated
Fire Extinguishers
Headliner Cabin (Suede) w/Battens
Owner's Manual
Sliding Windows & Screens
Wire for Stereo
120 Volt Duplex Outlets

COCKPIT

Access Hatches to Engine Room
Cockpit Storage Lockers
Transom Door

BRIDGE

Bridge, Settee w/Weather Covers
Control, Upper Helm w/Hydraulic Steering,
MMC Electronic Clutch & Throttle Controls,
Full Instrumentation & Compass
Light, Dash (12 Volt)
Pilot Seats w/Weather Covers (2)
Windshield, Tinted Plexiglass

OPTIONAL EQUIPMENT

DELUXE OPTION GROUP

Battery Charger, 20 Amp
Battery, Extra 105 Amp w/Switch
Engine Hour Meters
Transom Step Swim Ladder
Trimtabs (Single or Dual Station)
w/Rocker Switches

LXS OPTION GROUP

Battery, Extra 105 Amp w/Switch
Battery Charger, 20 Amp
Engine Hour Meters (2)
Fuel/Water Separating Filters (RACOR)
Head, Galley Maid, w/Holding Tank
12 Volt Waterline Discharge Pump
& Deck Discharge
Lights, Indirect (Tube) (12 Volt)
on Steps (Interior)
Strainers, Intake Water
Transom Step Swim Ladder
Trimtabs (Single or Dual Station)
w/Rocker Switches

SAFETY OPTION GROUP

Carbon Monoxide Detector, Interior
Fire Extinguishing System, Fireboy
(Halon) (MA)
Gas Detector (Sniffer) Single Station
High Water Level Alarm, Bilge

*Options in the above groups are offered only as stated, with no substitutions, additions, or deletions.

MECHANICAL

Electrical Outlet (120 Volt) Exterior
(w/Ground Fault Interrupter)
(Specify Location)
Generator, 4.0 KW (Gas) (FWC)
Generator, 6.5 KW (Gas) (FWC)
Propellers, Extra Set
Propeller Shaft, Extra, w/Coupling
Rudder Angle Indicator, Single Station
Rudder Angle Indicator, Dual Station

EXTERIOR

Anchor Windlass, Rope (Maxwell Nilsson)
Cockpit Table
Mast w/Light, Arch (Not Hinged)
Shower, Remote Mount, Cockpit, Fresh Water
Shower, Remote Mount, Cockpit, Raw Water
Washdown Pump (Raw Water Outlet Forward,
Fresh Water Outlet Aft)

INTERIOR

Air Conditioning, Reverse Cycle (12,000 BTU's)
AM-FM Stereo Cassette w/Speakers
Control Station, Lower Helm w/Full
Instrumentation, MMC Electronic Controls,
Compass and Windshield Wipers

30' SPORT CRUISER (Continued)

Heater, 120 Volt
Microwave Oven w/3 Burner (120 Volt)
Range Top
Red Dot Heater (Hot Water)
Teak & Holly Sole, Galley & Dinette

MISCELLANEOUS

Labor to Install Customer's Transducer
Labor to Install Customer's Radar Cable
Hull Shipping Cradle

DECOR OPTIONS

Hampton Seas
Pizzazz
Sundance

CUSTOM DECOR UPGRADES

Renaissance Jewel
Sea Breeze